

EE30/7 - Through Hole

HORIZONTAL 10 PINS STK1822-302-002

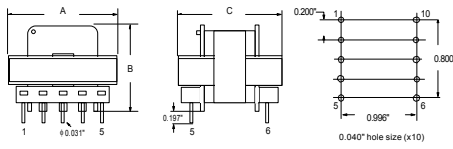

A MAX.	B MAX.	C MAX.
1.250"	0.850"	1.250"

E21 - Through Hole

HORIZONTAL-16 PINS STK1842-313-003

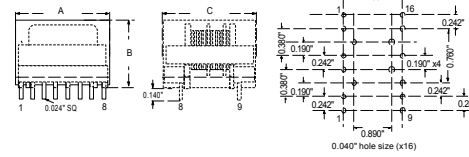

A MAX.	B MAX.	C MAX.
1.800"	1.230"	1.450"

E375 - Through Hole

HORIZONTAL-12 PINS STK1831-331-002

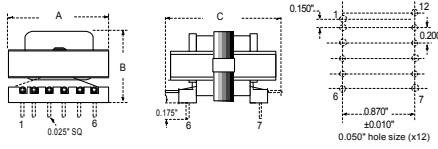

A MAX.	B MAX.	C MAX.
1.500"	1.020"	1.400"

HORIZONTAL-12 PINS STK1842-331-006

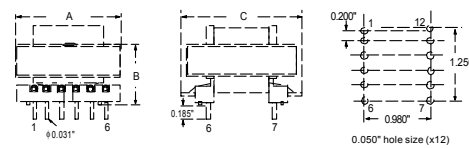

A MAX.	B MAX.	C MAX.
1.650"	1.250"	1.550"

HORIZONTAL-12 PINS STK1831-331-004

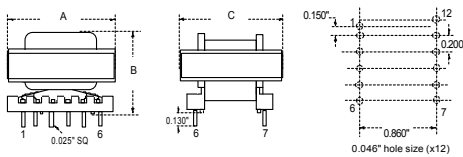

A MAX.	B MAX.	C MAX.
1.500"	1.250"	1.350"

VERTICAL- 6 PINS STK1842-412-11001

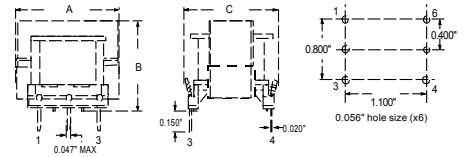

A MAX.	B MAX.	C MAX.
1.750"	1.430"	1.400"

HORIZONTAL- 6 PINS STK1831-431-002

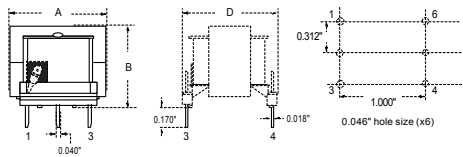

A MAX.	B MAX.	C MAX.
1.395"	1.213"	1.150"

EE42/20 - Through Hole

HORIZONTAL-12 PINS STK1849-302-001

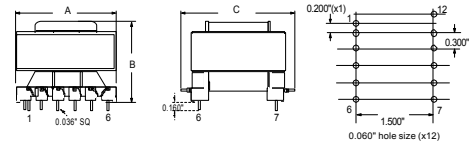

A MAX.	B MAX.	C MAX.
1.830"	1.750"	1.875"

EE42/20 - Through Hole

VERTICAL 18 PINS STK1849-431-001

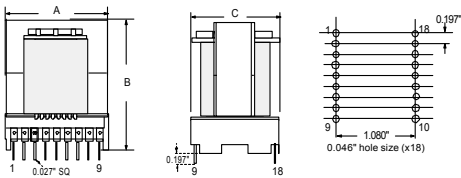

A MAX.	B MAX.	C MAX.
1.890"	2.050"	1.600"

EFD15 - Through Hole/SMD

HORIZONTAL 8 PINS STK4815-302-11-001

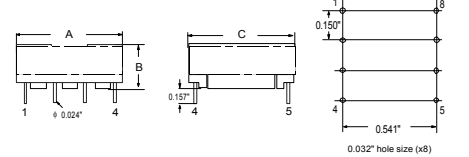

A MAX.	B MAX.	C MAX.
0.640"	0.350"	0.650"

VERTICAL 18 PINS STK1849-402-001

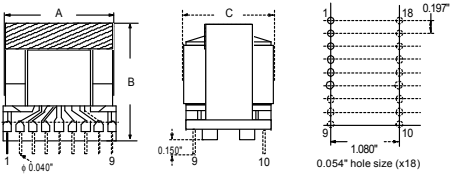

A MAX.	B MAX.	C MAX.
1.900"	2.070"	1.850"

HORIZONTAL 8 PINS STK4815-502-001

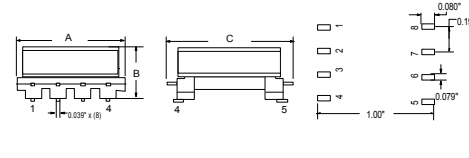

A MAX.	B MAX.	C MAX.
0.670"	0.360"	1.00"

EE625 - Through Hole

HORIZONTAL-12 PINS STK1862-313-001

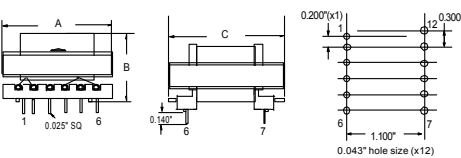

A MAX.	B MAX.	C MAX.
1.920"	1.320"	1.650"

EFD20 - Through Hole/SMD

HORIZONTAL 8 PINS STK4820-302-002

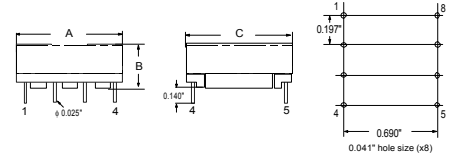

A MAX.	B MAX.	C MAX.
0.830"	0.480"	0.860"

EE55/21 - Through Hole

HORIZONTAL-20 PINS STK1855-331-001

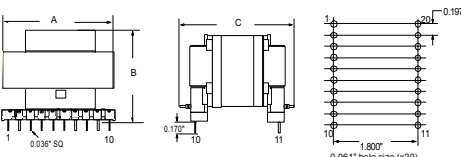

A MAX.	B MAX.	C MAX.
2.400"	2.050"	2.375"

HORIZONTAL-10 PINS STK4820-542-001

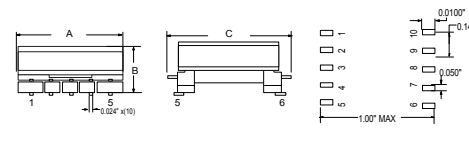

A MAX.	B MAX.	C MAX.
0.875"	0.410"	1.130"